



Malviya Mansion

2 & 3 BHK Deluxe Flats

Opp. St. Karen's School, Khagaul Road, Danapur, Patna

on going project...



WINSOME PARK PHASE -I



WINSOME PARK PHASE -II



WINSOME PARK PHASE -III

A project by



BUILDERS

An Innovative Infrastructure Company

L.H.O : Gola Road, Adi Shakti Market, Near Gurukul School, Danapur Cantt, Patna-801503

Mob.: 9304426279, 9334994319, winsomebuilders@gmail.com

www.winsomebuilders.in

Fit in to the luxurious Life You and your loved ones always wanted.

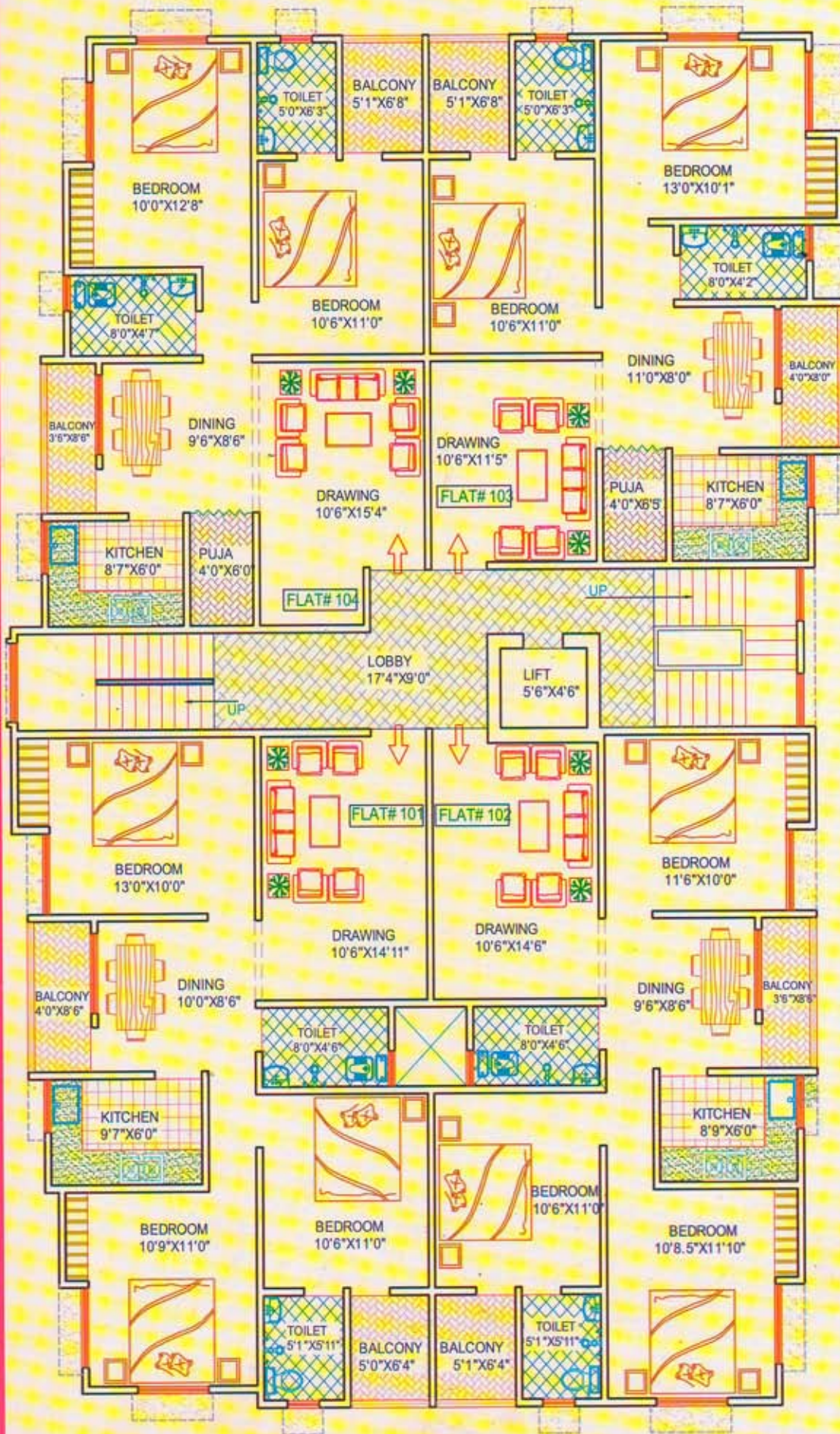

FLAT NO.	SUPER B/U. AREA
FLAT #101	1160 SFT.
FLAT #102	1125 SFT.
FLAT #103	970 SFT.
FLAT #104	975 SFT.

SPECIFICATION

RCC Framed Earthquake resistant structure.

- A. Entrance Lobby:**
1. Impressive Entrance Lobby.
 2. Name Plate & Letter box for each flat.

- B. Floor**
1. Common area finished with marble / rustic tiles.
 2. Antiskid flooring for Balcony/ Bathroom.
 3. Designer vitrified tiles of 2'x2' for rest part.

- C. Kitchen**
1. Kitchen platform with black granite/ marble top.
 2. Designer kitchen dado wall with 2' height ceramic tiles.
 3. Concealed plumbing with premium quality pipes.
 4. S.S. Sink.
 5. Provision for exhaust fan.

- D. Bathrooms**
1. A combination of designer tiles for flooring & dado in bathrooms up to 7' height.
 2. Provision for Hot & Cold water system.
 3. Concealed plumbing with premium quality pipes.

- E. Electrical**
1. Concealed fire resistant high electrical copper wiring.
 2. Provision for adequate lights & power Points as well as Telephone & TV outlets with protective MCBS.
 3. Provision for Cable, telephone intercom.

- F. Value Additions**
1. Fire fighting system.
 2. Superior internal OBD wall finish.
 3. Superior washable cement paint for external wall.
 4. Lifts by OTIS or equivalents.
 5. 24 hrs. power backup.
 6. Timely Possession.